

# ICU COLLEGE OF LIBERAL ARTS

INTERNATIONAL  
CHRISTIAN  
UNIVERSITY  
2026

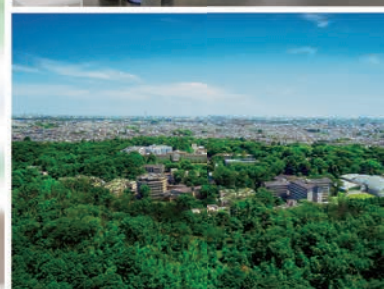

国際基督教大学  
INTERNATIONAL CHRISTIAN UNIVERSITY  
Tokyo, Japan

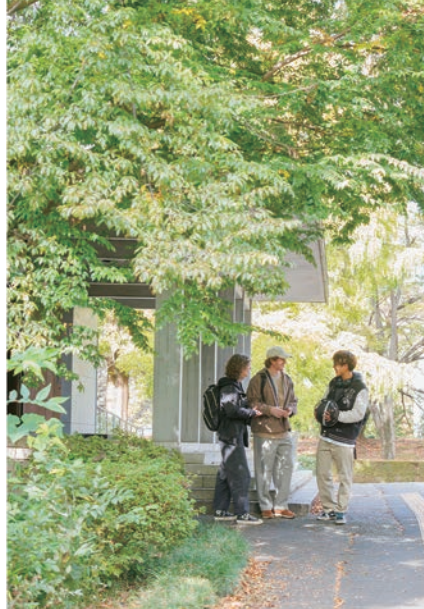





## Why Choose ICU? The Top Choice for International Students

### Japan's Premier Liberal Arts College and Graduate School

The International Christian University (ICU) has been a pioneer in liberal arts education in Japan since its founding in 1953.

### Bilingual Education

Japanese and English are the official languages at ICU. This bilingual commitment reflects ICU's internationalism and the promotion of mutual understanding and exchange. Courses are offered both in Japanese and English.

### Japanese Language Education

ICU's Japanese Language Program (JLP) is one of the world's best and helps students, from beginners to advanced learners, develop the skills needed to thrive academically and professionally in Japan.

### Engaging Learning Environment

The ICU campus includes modern facilities and a 620,000 m<sup>2</sup> wooded campus, offering a unique and unparalleled setting in the greater Tokyo area.

### A Diversity-Rich Campus

Japanese and non-Japanese students and faculty, representing a wide range of linguistic and cultural backgrounds, study, work, and live together, learning to serve the needs of an emerging and interconnected world.

### Top Private University in Japan

ICU was ranked as the leading private university in Japan in the Times Higher Education's Japan University Rankings in 2019, 2020, 2021, 2023 and 2025.





Tokyo provides a unique opportunity to study in one of the safest and most modern metropolises in the world. With its efficient transportation system, students can explore a blend of traditional heritage and cutting-edge innovation. Home to prestigious universities, Tokyo offers world-class education, cultural immersion, professional opportunities, and support for international students, all in a vibrant and globally connected environment.

THE Japan University Rankings



**No.1**

(Private University in 2019, 2020, 2021, 2023, 2025)

Full-Time Faculty with Overseas Experience



**88.7%**

Employment Rate



**91.8%**

Further Education Rate



**22.4%**

Books Checked Out per Student



**32.3**  
Annually

(National average: 5)



\*As of Autumn Term, 2024

Mitaka Woodland



**117** Families  
**545** Species

(Based on the 2009–2011 survey)

On-Campus Dormitories



**10**  
Buildings



On-Campus Dormitories Capacity



**900**  
Students

(1/3 of the total student population)

Average Class Size



**21**  
Students

Undergraduate Enrollment



**2,978**  
Students



# ICU

## An Educational Sanctuary in Tokyo's Vibrant Metropolis

International Christian University (ICU) is located on a campus of roughly 620,000 square meters. Our classroom buildings and research facilities are surrounded by the Musashino woods, dotted with student dormitories and faculty housing. The western side of the campus adjoins the Tokyo Metropolitan Nogawa Park. With its rich natural surroundings, ICU is a great place to enjoy university life.



### ICU Mitaka Campus Woodland in Tokyo

The Japanese Ministry of the Environment certified this campus as a Nationally Certified Sustainably Managed Natural Site in October 2023.



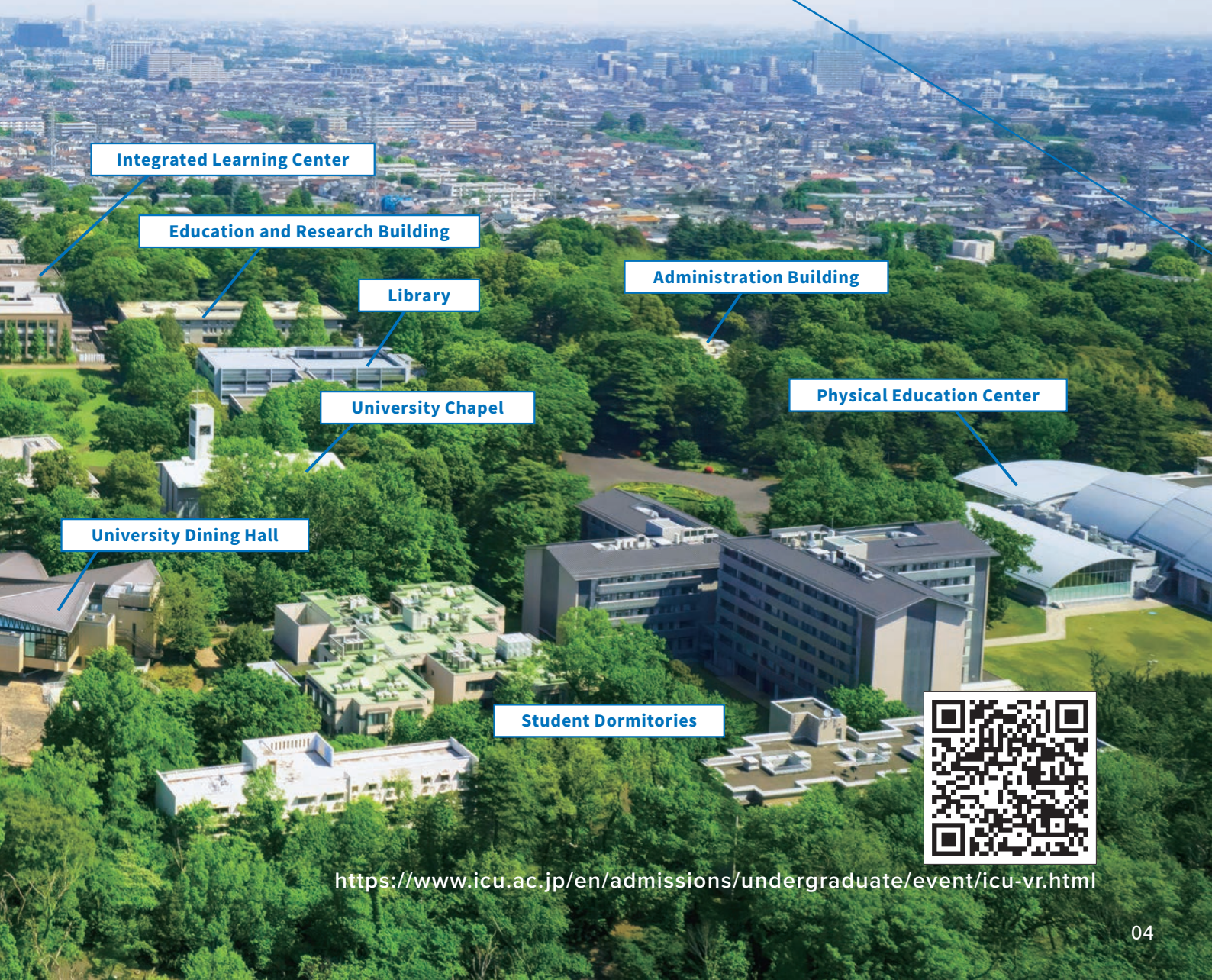
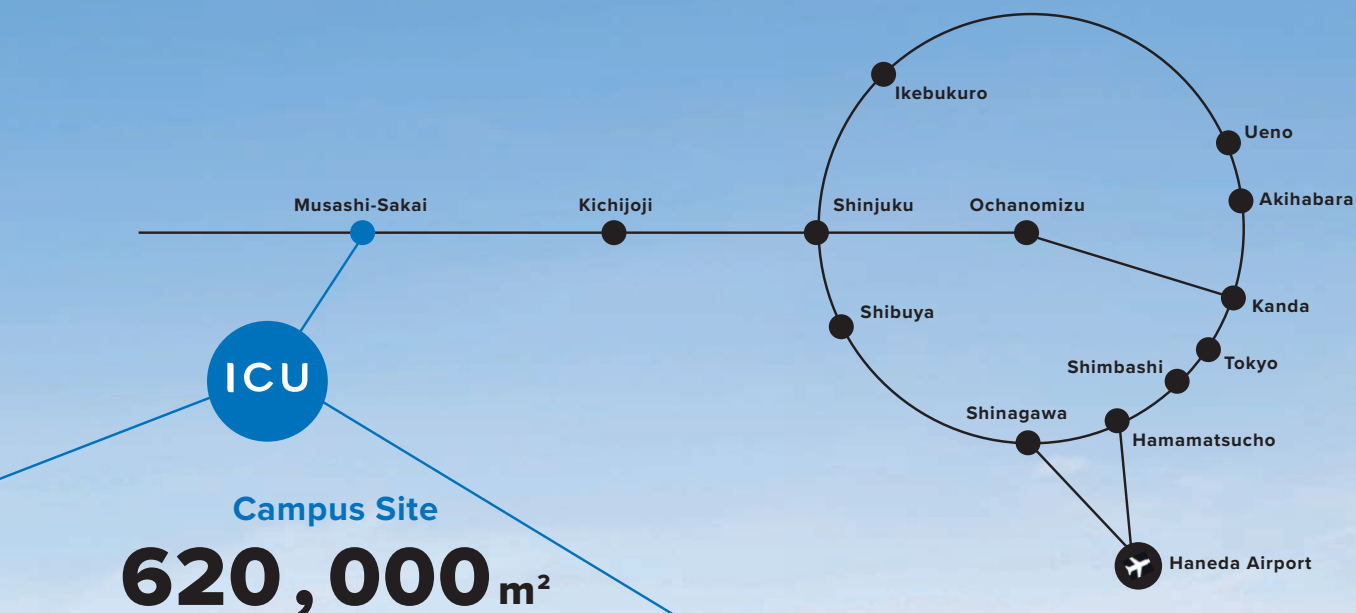

<https://www.icu.ac.jp/en/admissions/undergraduate/event/icu-vr.html>



*Message from the Dean*

# Quality Education for Future Global Leaders

Thank you for considering ICU for your college education. There are several clear advantages of choosing ICU. First, we offer an excellent liberal arts education with an international perspective. ICU was ranked as Japan's best private university in 2025 in the Times Higher Education's Japan University rankings. Second, at ICU with its bilingual education, you will learn to communicate effectively in Japanese and in English. This skill will allow you to serve as a competent bilingual person in both the professional and academic world. Third, you will have the opportunity to explore a wide range of academic disciplines. ICU offers 31 majors in the humanities, social sciences, natural sciences, and interdisciplinary studies, and you are encouraged to develop interdisciplinary thinking. Fourth, ICU aims to instill leadership characteristics in our students by providing a creative, rational, and ethical education.

We live in a globally interconnected society with many problems which can only be solved collaboratively.

More than ever, we need vigorous leaders with vision who can develop and implement creative, rational, and ethical solutions to address global challenges.

Thus, by taking advantage of these opportunities at ICU, you will be able to acquire necessary skills to meet the challenges of this global era.

As an international university, ICU seeks excellent students from all over the world. Your unique educational and cultural background will be an asset in our diverse campus community, and you will benefit from interacting with students and faculty members who are also unique and diverse.

An ICU education opens doors to a variety of international careers and advanced educational opportunities. Furthermore, your time at ICU will spark a desire and curiosity to be a lifelong learner. ICU will help you prepare not simply for a career but also for a meaningful life of learning. I hope that you will consider applying to ICU.



Natsumi Ikoma, Ph.D.  
Dean of the College of Liberal Arts





# Japan's Premier Liberal Arts College

In recent years, more leading figures have advocated for the value of a **liberal arts education**. Global challenges, such as environmental degradation and race relations, demand flexible, free-thinking approaches that go beyond narrow specialization.

To build a sustainable society, we need responsible global citizens who can transcend differences in race, nationality, ideology, and culture. Advances in cutting-edge fields such as genetic engineering have also ushered in an era where even living organisms can be designed, requiring interdisciplinary approaches that span the arts and sciences.

ICU, Japan's premier **liberal arts college**, has been at the forefront of addressing these needs. With its commitment to fostering global citizens and innovative thinkers, ICU offers a dynamic curriculum that integrates both traditional and contemporary academic disciplines.

Liberal arts education helps students reflect on how to live their life, develop a worldview, and address complex questions of human existence, providing a foundation for adaptability and critical thinking in an ever-changing world.



## Design your 4 Years at ICU

Reflecting the policy of “**later specialization**,” students learn about various areas of study by taking General Education and Foundation Courses during the 1st and 2nd year to identify their individual interests and capabilities. Students are also required to take the assigned courses of the Japanese Language Program (JLP) during the first two years.

ICU encourages its students to nurture a broad view of the world, cultivate flexible thinking by experiencing different areas of knowledge, and form a comprehensive, versatile academic foundation before beginning the process of selecting a major at the end of their 2nd year. Even after their major declaration, students can take courses from any major to enhance interdisciplinary study. As a culmination of their studies, all fourth-year students write a senior thesis on a topic of their choosing either in Japanese or English.

With the **5-year Program**, it is possible to obtain both a bachelor's degree and a master's degree in a total of 5 years, 4 years at the undergraduate level and 1 year at the graduate level.

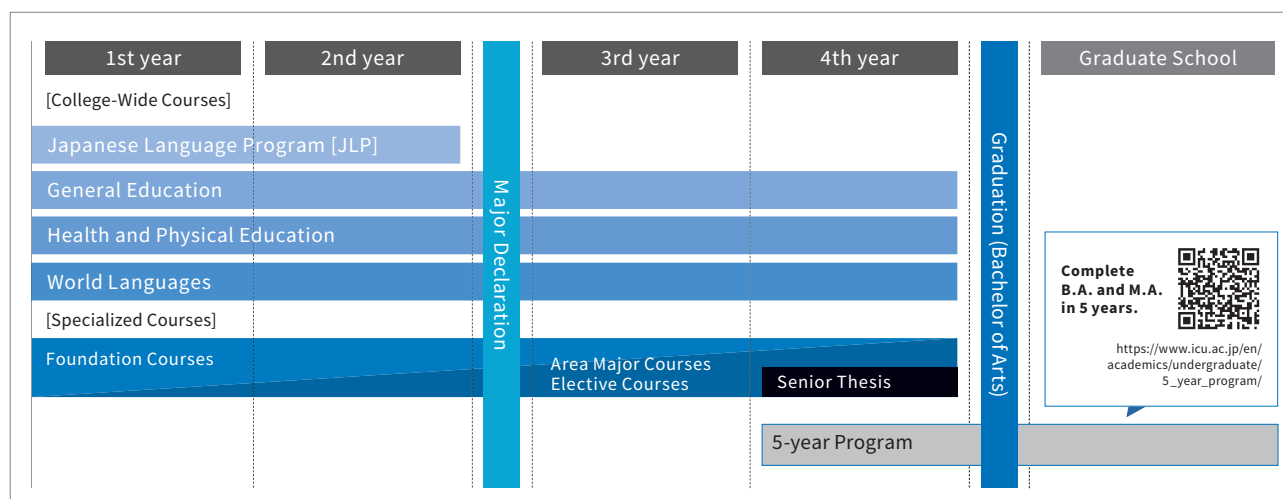



# 31 Majors

Students can select from 31 majors and design their educational experiences in different formats, including single, double, or major/minor combinations, each with varying credit requirements for graduation.

In their first and second years, students take a wide range of courses to nurture foundational academic abilities, explore diverse fields, and gradually refine their areas of interest.

By the end of their second year, they declare their major, double major, or major and minor, setting a focused direction for their final years of learning.

## SINGLE MAJOR

## DOUBLE MAJOR

(completing two full majors)

## MAJOR + MINOR

(selecting two “majors” but emphasizing one over the other)



### Art and Cultural Heritage

Learn the “past” through art and cultural heritage, and pursue the deeper meaning that lies hidden in those works.



### Music

Music studies at ICU focus mainly on music history and theories of musical cultures, analyzing and comparing the different meanings that music holds in society.



### Literature

Develop our intellectual and emotional understanding of the world and human beings through literature.



### Philosophy and Religion

Explore the ideas of existence, recognition, ethics, society, belief, and God through classics that transcend the ages from all around the world.



### Economics

An academic discipline that forms the foundations for deeply understanding contemporary society and formulating measures to address numerous challenges.



### Business

The appeal of the business major is that it is a useful discipline that will be helpful when you try to achieve something with others in social activities.



### History

Observe many regions and cultures around the world throughout the course of time.



### Law

Exploring Justice, Human Rights and Representations of People.



### Public Policy

Make practical and constructive policy recommendations through a “problem-solution-oriented approach”.



### Politics

Political changes bring about changes in the world. Acquire the “art” of applying political knowledge within real society.



### International Relations

Understanding contemporary international relations through thorough discussions at ICU, a bilingual education institute.



### Sociology

Critical tools to understand social trends and problems.





## Cultural Anthropology\*

Study the possibilities of humankind.

\*From April 2026, the Anthropology major will be renamed the Cultural Anthropology major.



## Media, Communication and Culture

In MCC major, we take a critical look at the ever-changing media and communication processes.



## Biology

Clarify the diversity of life and its mechanisms.



## Physics

Discover the truths behind the natural world and apply this knowledge to technology.



## Chemistry

Explore material changes in the natural world and human activities.



## Mathematics

Develop the ability to think logically, analytically, and flexibly through modern mathematics.



## Information Science

Combining the practical aspects of Information Science with more universal liberal arts learning.



## Language Education

Acquire the theoretical and practical knowledge and skills necessary for language education.



## Education

Understand the different forms of education around the world and become an education leader for the future.



## Linguistics

Explore the human nature through the scientific study of language.



## Psychology

Explore the core essence of human beings from the perspective of the mind and behavior.



## American Studies

Analyze American society in the Asia Pacific region to understand the relationship between the present and the future, and the future and the past.



## Asian Studies

Discover the diversity of the Asian region and nurture leaders who will co-exist in peace in the region in the future.



## Development Studies

Change the world through empowerment.



## Environmental Studies

Nurture global citizens with an interdisciplinary and global view of the environment.



## Gender and Sexuality Studies

Open a new academic horizon from the perspective of gender and sexuality.



## Global Studies

Acquire the courage and critical perspectives to take on the challenges of solving problems in the twenty-first century global society.



## Japan Studies

Provide a practical arena for considering various aspects of "Japan."



## Peace Studies

Blessed are the Peacemakers - Back to the Basics!

**Design your learning by choosing your own combination of 31 majors**



<https://www.icu.ac.jp/en/academics/undergraduate/major/>



# Japanese-English Bilingual Education

ICU seeks to develop students who can venture beyond their own social and cultural assumptions, engage in dialogue with unfamiliar values and perspectives, and discover themselves through new relationships with others. This process relies on developing exceptional communication skills, starting with mastery of both Japanese and English.

Since its founding, ICU has embraced bilingualism by designating Japanese and English as its official languages. To graduate, students must complete either the English for Liberal Arts Program (ELA) or the Japanese Language Program (JLP). These programs exemplify ICU's dedication to bilingual education, which is integral not only in the classroom but also in extracurricular activities and student clubs.

## Japanese-English Bilingualism

### ELA

#### English for Liberal Arts Program

A program designed to help students, primarily native Japanese speakers, develop the necessary English language skills.



Students who are primarily  
**NATIVE Japanese speakers**

### JLP

#### Japanese Language Program

A program designed to help students who are primarily non-native Japanese speakers, or students who have spoken Japanese only at home, acquire the necessary Japanese language skills.



Students who are primarily  
**NON-NATIVE Japanese speakers**

## Japanese Language Program (JLP)



<https://www.icu.ac.jp/en/academics/undergraduate/jlp/>

While many universities require students to have a certain degree of Japanese proficiency before enrolling, ICU admits students of all levels. New students with no prior Japanese experience can enroll in the Japanese Language Program (JLP) to acquire solid Japanese skills in around two years through intensive, small-class instruction. After completing these intensive courses, students can enhance their proficiency in Japanese to levels that allow them to take classes in Japanese.

Since its founding, the Japanese Language Program (JLP) has provided Japanese language courses to ICU students as part of the College of Liberal Arts. There are around 300 students from about 40 different countries enrolled in JLP courses every year, including degree-seeking regular four-year students, one-year exchange students, and graduate students. It is an opportunity for both international students and Japanese students to become proficient in Japanese. JLP aims to help students achieve functional communication competence in Japanese.

The goal of JLP is to equip students with proficiency in the Japanese language that will enable them to pursue academic studies in ICU. JLP hopes to provide the foundation upon which students can realize their full potential in today's dynamic and diverse world. The Japanese Track: Japanese as a Foreign Language covers all language skills, and students are expected to participate actively in classes that are kept relatively small. There are tutorial sessions where students can receive individual attention.



# “Dialogue-Oriented” Academic Advising and Planning Support

At ICU, the faculty advisor system and Academic Planning Support serve to support students through dialogue as they take the initiative in designing their own educational experiences.

Every student is assigned a full-time faculty member to serve as their Academic Advisor. In addition, there are also “Major Advisors” who assist with any questions students may have about their respective majors.

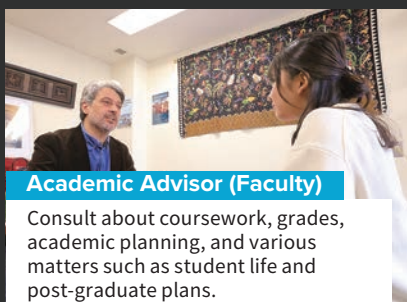

**Academic Advisor (Faculty)**

Consult about coursework, grades, academic planning, and various matters such as student life and post-graduate plans.



**Major Advisor (Faculty)**

Consult about Majors.



**Academic Planning Support (Staff)**

Consult about major declaration, resources for academic planning and post-graduate plans.



**ICU Brothers and Sisters (Students)**

**65.1%** of university staff hold a TOEIC score of 800 or higher (as of May 1, 2023).

Each office is staffed with personnel proficient in English, providing bilingual support for all tasks and assistance to international students.

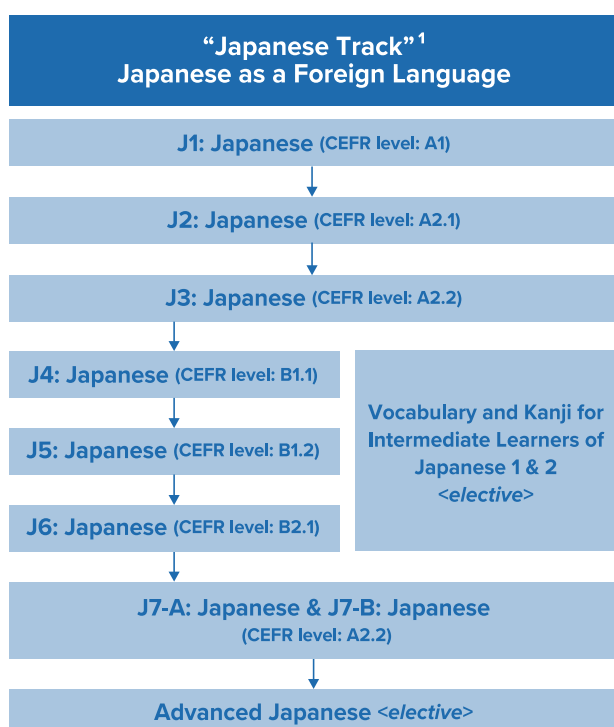

<sup>1</sup>If students complete the courses shown in this chart, they are deemed to have reached the equivalent level for CEFR<sup>2</sup>.

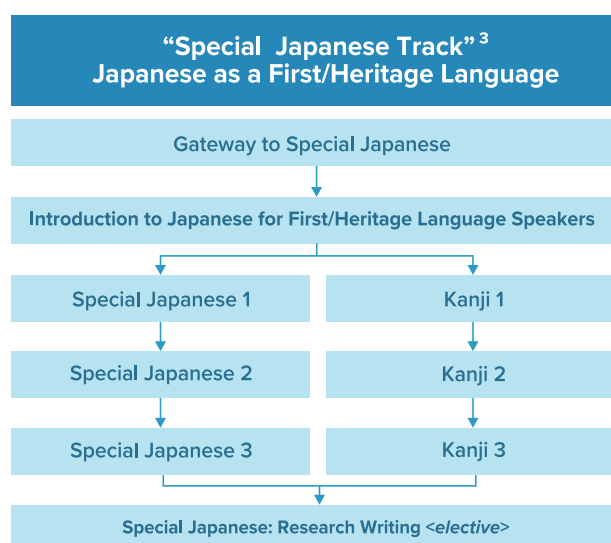

1: 4-Year Regular and Transfer Students placed in the “Japanese Track” are required to complete up to “J7-A: Japanese & J7-B: Japanese”.

2: The CEFR (Common European Framework of Reference for Languages) organizes language proficiency in six levels, A1 to C2. For more information, please refer to the following.  
<<https://www.coe.int/en/web/common-european-framework-reference-languages>>

3: 4-Year Regular and Transfer students placed in the “Special Japanese Track” are required to complete up to Special Japanese 3 and Kanji 3.



# International Programs

With the aim of providing its students with opportunities to study in institutions of higher education across the world, ICU has entered into partnership agreements with numerous universities and developed its own distinctive study abroad programs.



**North America**

**Canada**  
University of Alberta  
The University of British Columbia  
British Columbia Institute of Technology  
McGill University  
University of Victoria  
University of Windsor

**United States**  
University at Buffalo,  
The State University of New York  
University of California  
-Berkeley  
-Davis  
-Irvine  
-Los Angeles  
-Merced  
-Riverside  
-San Diego  
-Santa Barbara  
-Santa Cruz  
Drexel University  
Duke University  
Georgetown University  
Grand Valley State University  
Guilford College  
University of Massachusetts Amherst  
Middlebury College  
The University of North Carolina at Chapel Hill  
The Ohio State University  
University of Pennsylvania  
Pomona College  
Rutgers, The State University of New Jersey  
The University of Tennessee, Knoxville  
Washington and Lee University  
Washington State University  
Western Washington University  
Wilkes University  
The College of Wooster

**South America**

**Chile**  
Pontificia Universidad Católica de Chile

**Colombia**  
Pontificia Universidad Javeriana,  
Bogotá and Cali

**Europe**

**Belgium**  
Université Libre de Bruxelles

**Denmark**  
Aarhus University

**Estonia**  
University of Tartu

**Finland**  
Tampere University

**France**  
Université Paris Cité  
Université Toulouse Jean Jaurès

**Germany**  
Freie Universität Berlin  
University of Münster

**Iceland**  
University of Iceland

**Italy**  
Sapienza Università di Roma  
Middlebury School in Italy

**Lithuania**  
Vytautas Magnus University

**Netherlands**  
Maastricht University  
Tilburg University

**Poland**  
University of Warsaw

**Russian Federation**  
The Moscow State Institute of International Relations

**Slovak Republic**  
Bratislava International School of Liberal Arts

**Spain**  
Universidad de Málaga

**Sweden**  
University of Gothenburg  
Linnaeus University

**Asia**

**China / Hong Kong**  
The Chinese University of Hong Kong  
The University of Hong Kong  
Hong Kong Baptist University  
Lingnan University  
Nanjing University  
Nanjing Normal University

**India**  
Ashoka University  
Lady Doak College

**Indonesia**  
Atma Jaya Yogyakarta University  
Parahyangan Catholic University  
Petra Christian University  
Soegijapranata Catholic University

**Korea**  
Ewha Womans University  
Handong Global University  
Hannam University  
Keimyung University  
Korea University  
Soongsil University  
Yonsei University

**Philippines**  
Ateneo de Manila University  
De La Salle University  
University of the Philippines  
Silliman University

**Singapore**  
National University of Singapore

**Taiwan**  
Fu Jen Catholic University  
National Chengchi University  
Tungshai University

**Thailand**  
Mahidol University  
Thammasat University

**Oceania**

**Australia**  
The University of Queensland  
Queensland University of Technology

**New Zealand**  
The University of Auckland  
The University of Waikato



<https://www.icu.ac.jp/en/academics/undergraduate/global/>

## International Summer Program in Japan (ISPJ)

<https://sites.google.com/info.icu.ac.jp/icu-ispj/home>



Every July, ICU hosts a summer program on its campus. The International Summer Program in Japan (ISPJ) brings together Japanese language learners from around the world and ICU students interested in Japan studies to study various aspects of Japan. The program is composed of the following two components.

- 1. Japanese Language Module :** task-based (previous Japanese language study required)
- 2. Japan Studies Module :** thematic omnibus component focusing on various aspects of Japan, such as culture, history, society, economics, art, philosophy and religion, and environmental issues.

In addition to classroom lectures and discussions, students actively learn through off-campus field trips, Japanese cultural programs, and student life experiences in Japan. During the program, students will stay in the on-campus dormitory with participants from different countries and will be able to experience cross-cultural exchange while living in Japan.



# ICU Alumni



<https://www.icu.ac.jp/globalicu/en/interviews/global-alumni/>



## Paths after ICU

Diverse opportunities await ICU graduates, thanks to their liberal arts education. Each year, approximately 70% of graduates enter the workforce, while around 20% pursue further education. Among those continuing their studies, some take advantage of programs that allow them to earn both bachelor's and master's degrees in a shorter timeframe, such as the ICU 5-year Program or the Accelerated Entry Program in partnership with the Middlebury Institute of International Studies at Monterey.

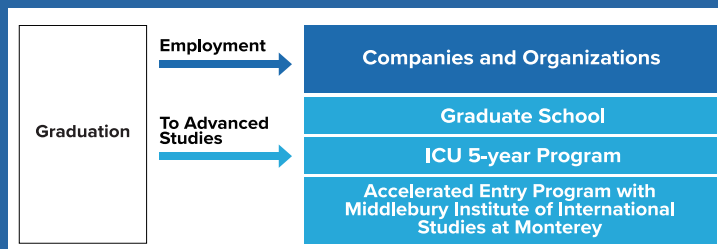

## Employment

A wide range of career opportunities highlights the high expectations for globally active ICU graduates. The employment rate consistently exceeds 90% each year, reflecting the strong demand for their skills. ICU graduates are equipped to make comprehensive judgments, think creatively, and utilize advanced language abilities. With the adaptability to meet the needs of a borderless and rapidly evolving society, they secure positions across diverse industries, particularly with globally oriented companies.

### Companies Employing ICU Graduates

Accenture Japan Ltd / Bloomberg L.P. / Deloitte Tohmatsu Consulting LLC / Deloitte Touche Tohmatsu LLC / EY Advisory & Consulting Co., Ltd. / Japan Airlines Co., Ltd. / Leverages Co.,Ltd. / NHK / PwC Consulting LLC / Tata Consultancy Services Japan, etc.

## Further Education

ICU is known for having a significant number of students who choose to pursue graduate studies. These students seek to deepen their understanding of research topics explored during their liberal arts education or to prepare for careers in international organizations.

Many students with strong English language skills aim to pursue graduate studies abroad. Additionally, many ICU alumni work in the fields of education and research.

### Graduate Schools Accepting ICU Graduates

Japan	ICU / Univ. of Tokyo / Hitotsubashi Univ. / Univ. of Tsukuba / Kyoto Univ., etc.
Overseas	Middlebury Institute of International Studies at Monterey / University of Leeds / London School of Economics and Political Science / University of California, Davis / The University of Melbourne, etc.



# International Students

International students at ICU come from diverse educational backgrounds, representing over 50 countries and regions, regardless of their nationality. Together, they learn and grow in a richly diverse environment on the ICU campus.

This dynamic environment fosters open-mindedness and cultivates the skills needed to build trust within the international community, shaping students into true global citizens.

**50+**

Countries & Regions  
Represented by Students

**837**

The number of applicants  
educated under a foreign  
education system (AY 2024)

**Over 50%**

Number of students opting for overseas  
study experience

**2 + 1**

Multilingualism

**35.9%**

Courses taught in English  
(AY 2022)

**36.6%**

Graduation Theses in English  
(AY 2022)

\*As of Autumn Term, 2024

## Exploring the Frontier of Liberal Arts in Japan

I chose ICU for its expansive course offerings and bilingual curriculum. I also found great value in the opportunity to study true liberal arts in Japan, surrounded by a beautiful natural environment. Currently, I am studying biology and writing a thesis on the ecology of marine organisms. I highly recommend ICU for several reasons: you can build strong friendships with students from all over the world, learn from dedicated professors who genuinely care about their students, and challenge yourself to pursue whatever interests you. No matter what path I take in the future, my experience at ICU will be a lifelong asset.

**Kai** Japan

Saint Maur International School

Class of 2025

Single Major





## Beyond Law: Finding New Paths to Peace

Growing up in the U.S., I chose ICU to study global issues beyond an American lens. I explored fields like economics, law, and education to confirm that international relations was the right path for me. A discussion in an international law class about conflict in the Middle East made me question whether solutions might exist beyond legal institutions, such as mediation. It sparked my interest in mediation and helped me see that alternative international dispute resolution has real-world applications and paths worth exploring. ICU's liberal arts education encouraged me to discover my true passions, and I hope others can do the same.

**Julia** *United States*

Iolani School

Class of 2025

Major + Minor



International Relations



Public Policy

## Connecting with the world through languages

I chose ICU for its unique, intensive JLP (Japanese Language Program) to acquire Japanese as a third language. As someone who is bilingual (English and Mandarin), I understood the value of knowing multiple languages to connect with others of different linguistic and cultural backgrounds. I am currently majoring in Education with a minor in Literature, with the goal of becoming an IB (International Baccalaureate) teacher in an international school. I highly recommend ICU as it provided me with comprehensive academic support to acquire Japanese as a third language, alongside connecting me with students of diverse backgrounds who shared the common goal of building fluency in Japanese. Being a recipient of the Global Citizenship Scholarship, I treasure these cross cultural experiences ICU has given me throughout my 4 years of study.

**Kaiyi** *Singapore*

Hwa Chong International School

Class of 2025

Major + Minor



Education



Literature

ICU International Christian University





# Club Life And Activities



<https://www.icu.ac.jp/en/campuslife/club/>

Extra-curricular  
Activities

Over **100**

ICU students are engaged in a variety of extracurricular activities in the arts, sports, music and cultural fields. Events including the ICU Festival, Christian and International Weeks and the Dormitory Festival are planned and carried out by students. Currently, there are over 100 officially recognized clubs and various independent groups active at ICU.



# Student Housing

ICU dormitories are a place where students foster respect for human rights and diversity and learn to share responsibilities and duties through dialogue in a communal living. All dormitories are located on campus, set in natural surroundings where students can enjoy the changing seasons. They are conveniently located near facilities such as the University Hall, the University Cafeteria and the Library.



**30% of students live on campus**  
(10 buildings housing a total of approximately 900 people)



**Students Play a Key Role in Dorm Operations**

Dormitories at ICU bring together students from diverse backgrounds, ages, personalities, languages, cultures, and religions to live and interact closely. While disagreements may arise, these experiences, debating late into the night, embracing differences, and working together to resolve conflicts, play a vital role in fostering personal growth. By the time students graduate and leave the dorms, they will have developed key skills for thriving in a global society, including an appreciation for diversity, effective communication, leadership and management abilities, teamwork, and advanced problem-solving skills.

## FLOOR PLAN

■ Room shared by two people (Canada House)

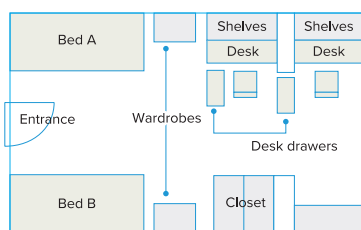

■ Room shared by two people (Ginkgo House)

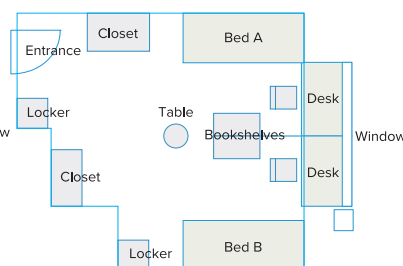

## Dormitory Fees (AY 2025)

Entrance Fee	¥62,000
Dormitory Fee	¥257,500 - ¥539,000 / year



<https://www.icu.ac.jp/en/campuslife/dormitories/>



**Opportunities to  
Make Friends for Life**



# Admissions

In line with its goal to cultivate responsible global citizens, ICU seeks to admit students, irrespective of nationality, who can strive academically and personally at ICU. The admissions process aims to identify students who can perform at a superior level in a liberal arts environment. Moreover, coming from diverse educational and cultural backgrounds, students are expected to enrich the ICU student body with different and innovative ways to meet the challenges of the new global age.

All the processes from applications through results are completed online alone. This allows us to accept applications from all over the world. There is no need for applicants to physically visit our campus to complete applications or take an interview. Admissions decisions are made holistically, and all the components are equally important, from academic transcripts, application essays, and letters of recommendation, to the standardized test scores (for Type A applicants) or the online interview (for Type B applicants).

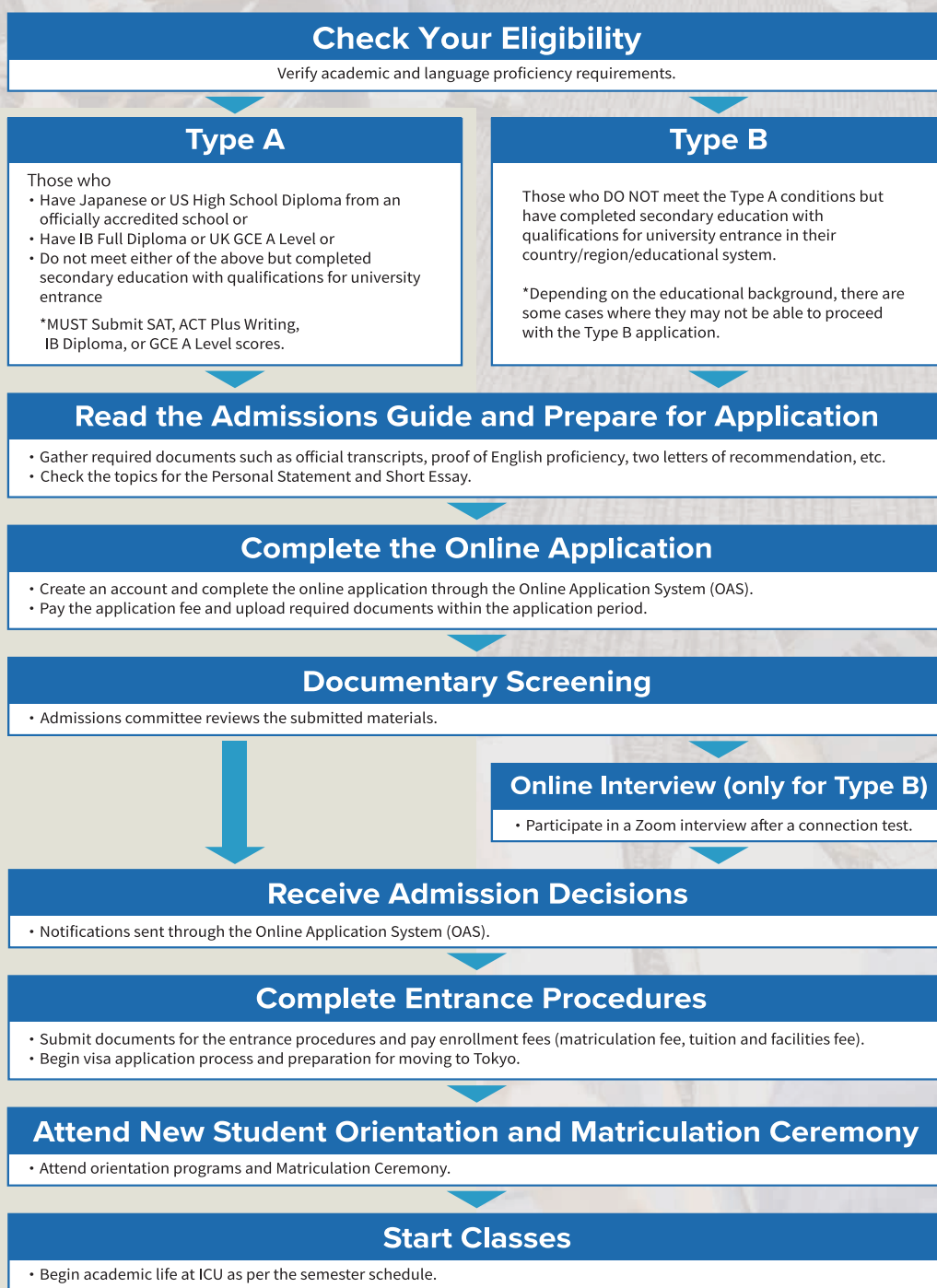

#### Eligibility Criteria

<https://www.icu.ac.jp/en/admissions/undergraduate/engdoc/categories/>



#### Application Documents

<https://www.icu.ac.jp/en/admissions/undergraduate/engdoc/documents/>



#### Online Application System (OAS)

<https://www.eraku-p.jp/erp/icu-uads/>



<https://www.icu.ac.jp/en/admissions/undergraduate/engdoc/>

For detailed information, check the Admissions Guide and Manuals on the website.

# Tuition and Fees

Matriculation Fee  
 Regular Students: ¥300,000  
 One-Year Regular Students and Kenkyusei: ¥150,000

Academic Year		Tuition	Facilities Fee	Total
AY 2026	Per Year	¥1,167,000	¥354,000	¥1,521,000
	Per Term	¥389,000	¥118,000	¥507,000
AY 2027	Per Year	¥1,203,000	¥354,000	¥1,557,000
	Per Term	¥401,000	¥118,000	¥519,000

# Financial Aid & Scholarships

ICU offers a variety of scholarships to support students in need of financial aid, including scholarships for students who are expected to be role models as ICU students, tuition reduction scholarships over four years, and scholarships to support students who have difficulty pursuing their higher education for social or financial reasons; all are designed to enable students to challenge themselves to the fullest in a fulfilling liberal arts education.

Scholarship	Before	1st Year			2nd Year			3rd Year			4th Year		
	Matriculation Fee	A	W	S	A	W	S	A	W	S	A	W	S
ICU Peace Bell Scholarship (Exemption)	✓	✓	✓	✓	✓	✓	✓	✓	✓	✓	✓	✓	✓
		Dorm Fees (Except July and August)											
University of Tomorrow Scholarship (Exemption & monthly stipend)	✓	✓	✓	✓	✓	✓	✓	✓	✓	✓	✓	✓	✓
		Monthly Stipend											
		Dorm Fees											
ICU Torch Relay High Endeavor Scholarship (including Global Citizenship Quota) (Exemption)	✓	✓	*		✓	*		✓	*		✓	*	
ICU Scholarship for International Students (Exemption)					✓	△		✓	△		✓	△	

Remarks:  
 A = Autumn Term, W = Winter Term, S = Spring Term (Tuition and Facilities Fees apply to all three terms)  
 ✓ = Supported by the scholarship  
 \* = only for recipients of the Global Citizenship Quota  
 △ = A minimum of one term of the tuition is waived, with a maximum of two terms waived.

## A Supportive Campus

ICU also provides support for students with different needs.

- Health Care Office
- Counseling Center
- Vegetarian dishes at University Cafeteria
- Muslim Prayer Room
- Nursing Room
- Learning Accessibility Services (LAS), etc.

## Our Christian Commitment

ICU’s commitment to a Christian philosophy enables us to explore and develop all dimensions of the human existence, including the religious. We believe a Christian institution of higher learning has a distinct contribution to make to the world. Although differences may arise in explanation, interpretation, or proposed solutions to certain human conditions, our scientific and descriptive tools are the same as those used by scholars at other institutions. Knowledge that is discovered and taught is not an end but carries with it certain implications, such as the responsibility for improving society. Through this environment, students learn that acquiring knowledge is not an end in itself: we believe in the essential unity of knowledge, faith, and action.



 Avg. 21 / 13 °C

SPRING

March - May

 Avg. 32 / 24 °C

SUMMER

June - August

## Four Seasons at ICU

 Avg. 24 / 18 °C

AUTUMN

September - November

 Avg. 13 / 6 °C

WINTER

December - February

### Directions to ICU

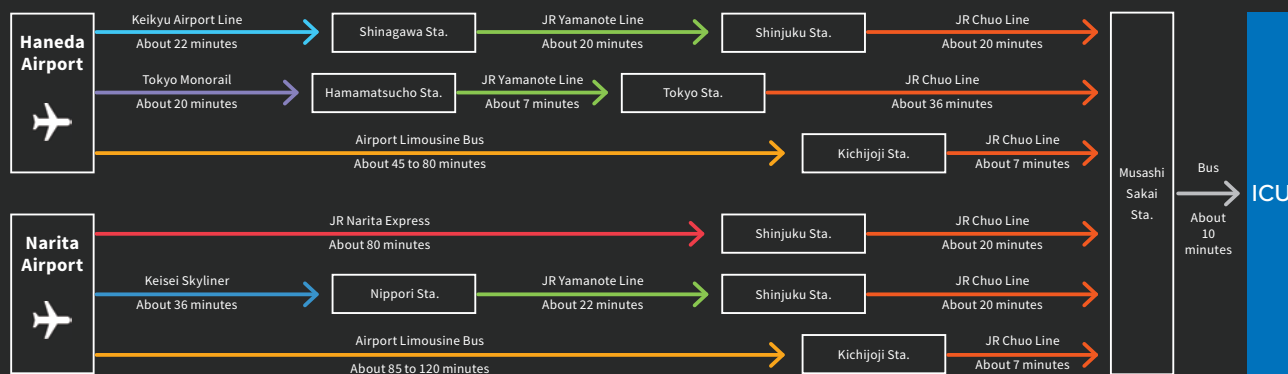

ICU Official Website

<https://www.icu.ac.jp/en/>

10 - 2 , Osawa 3 - chome, Mitaka - shi, Tokyo 181 - 8585, Japan Public Relations Office, International Christian University  
Tel + 81 - 422 - 33 - 3058 E-mail pro@icu.ac.jp

